

# Park Blvd - Retail Space

Pinellas Park, Pinellas County, FL

**CONTACT:**

Name: Christian Yepes  
 Phone: 727-536-8686  
 Fax: 727-536-4356  
 Email: christian@bdgfl.com

**Location:**

4590 Park Blvd  
 Pinellas Park, FL 33781

**Property Information:**

1.6 +/- Acres FULL ACCESS  
 Zoning: Commercial

**Traffic Counts:**

**Park Blvd: 62,300 cars per day**

**Space Available:**

4,688 sf Available (Drive Thru Available)

**Demographics:**

	<u>Population</u>	<u>Avg. Income</u>
1 mile:	12,970	\$49,380
3 miles:	101,849	\$50,687
5 miles:	265,511	\$56,100

**Notes:**

This property is located a thriving retail market on Park Blvd in Pinellas Park, FL. This site can be redeveloped into multiple uses. The property sits amid a very tight commercial retail corridor that presents high barriers to entry. There are over 62,000 cars per day on Park Blvd!



**NEW CONSTRUCTION - SPACE AVAILABLE**

4590 PARK BLVD • PINELLAS PARK, FL

# Park Blvd - Retail Space

Pinellas Park, Pinellas County, FL

**CONTACT:**

Name: Christian Yepes

Phone: 727-536-8686

Fax: 727-536-4356

Email: christian@bdgfl.com

**Location Map**

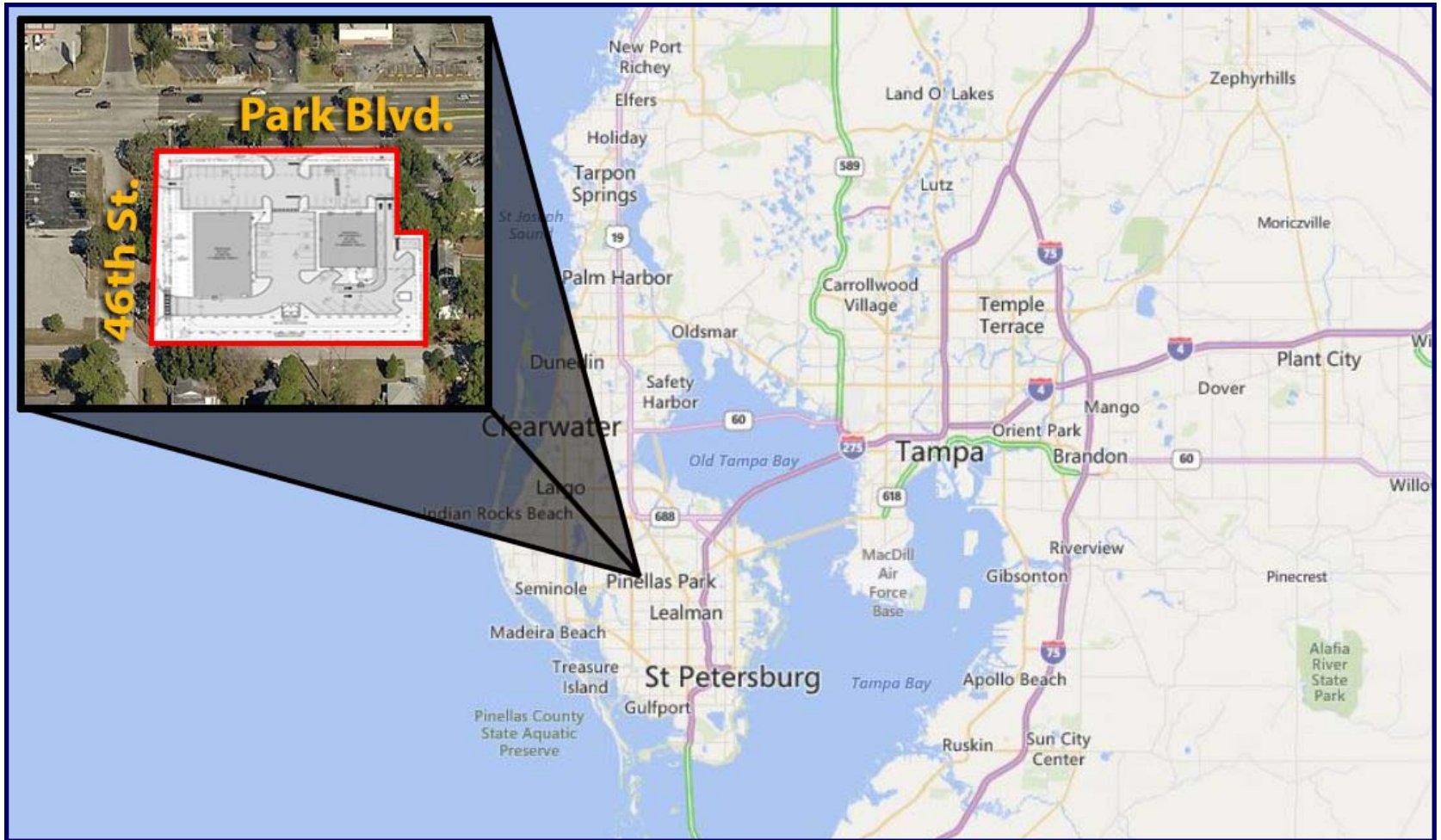

PHONE: 727-536-8686 • FAX: 727-536-4356 • BELLEAIR DEVELOPMENT GROUP



**NEW CONSTRUCTION - SPACE AVAILABLE**

4590 PARK BLVD • PINELLAS PARK, FL

# Park Blvd - Retail Space

Pinellas Park, Pinellas County, FL

**CONTACT:**

Name: Christian Yepes

Phone: 727-536-8686

Fax: 727-536-4356

Email: christian@bdgfl.com

Color Elevation



PHONE: 727-536-8686 • FAX: 727-536-4356 • BELLEAIR DEVELOPMENT GROUP

NEW CONSTRUCTION - SPACE AVAILABLE

4590 PARK BLVD • PINELLAS PARK, FL

# Park Blvd - Retail Space

Pinellas Park, Pinellas County, FL

**CONTACT:**

Name: Christian Yepes

Phone: 727-536-8686

Fax: 727-536-4356

Email: christian@bdgfl.com

**Site Plan**

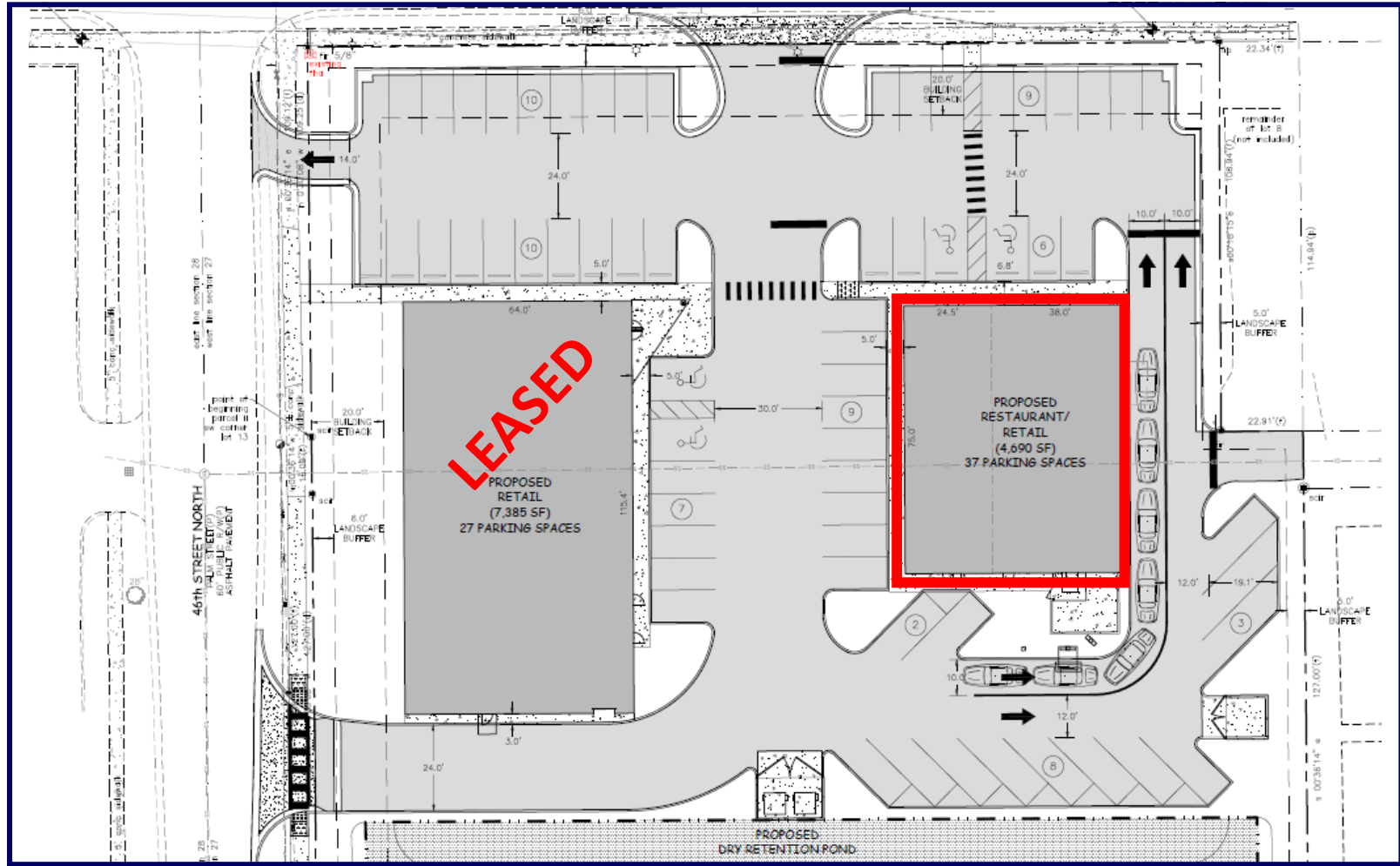

PHONE: 727-536-8686 • FAX: 727-536-4356 • BELLEAIR DEVELOPMENT GROUP



**NEW CONSTRUCTION - SPACE AVAILABLE**

4590 PARK BLVD • PINELLAS PARK, FL

# Park Blvd - Retail Space

Pinellas Park, Pinellas County, FL

**CONTACT:**

Name: Christian Yepes

Phone: 727-536-8686

Fax: 727-536-4356

Email: christian@bdgfl.com

Aerial View

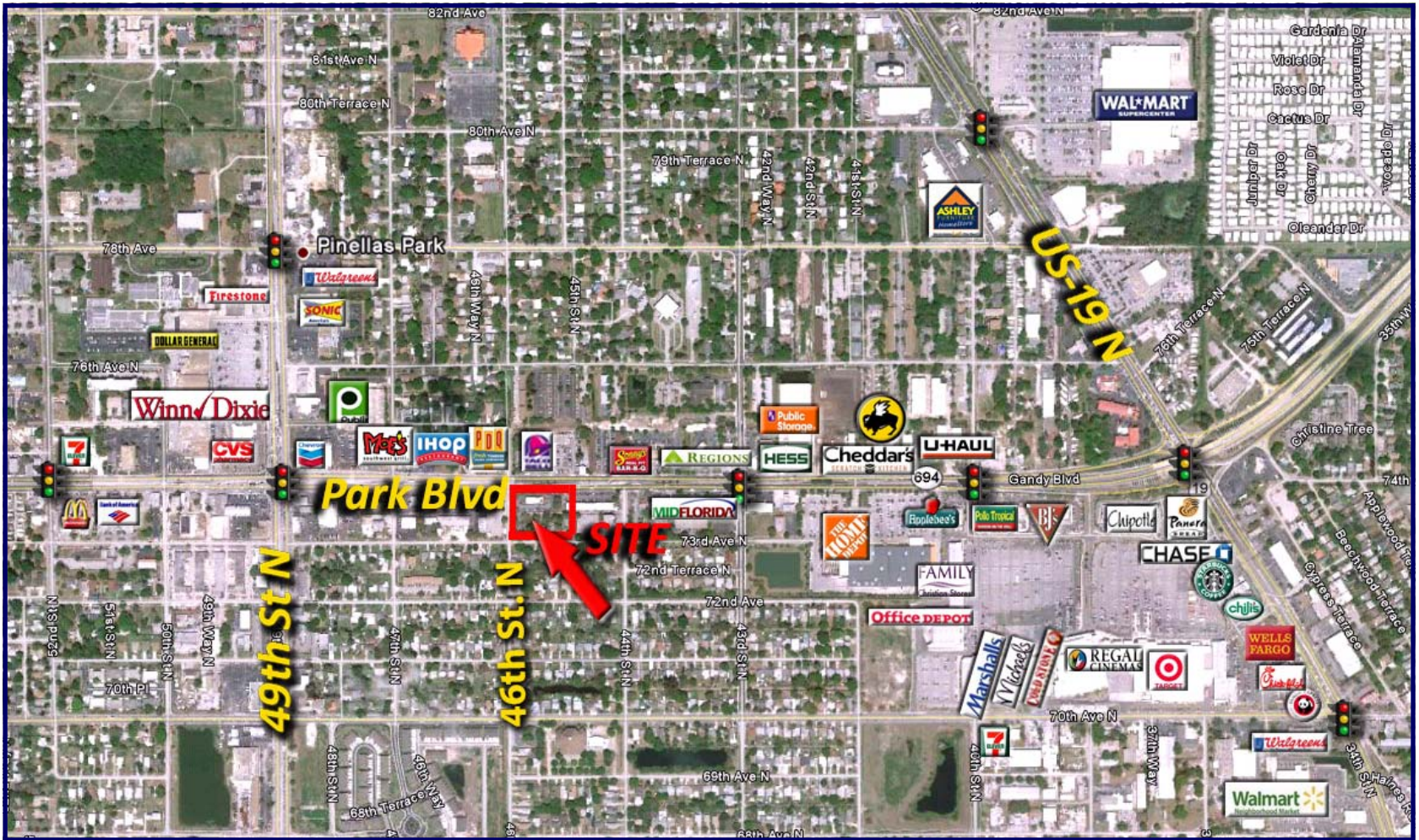

PHONE: 727-536-8686 • FAX: 727-536-4356 • BELLEAIR DEVELOPMENT GROUP



NEW CONSTRUCTION - SPACE AVAILABLE

4590 PARK BLVD • PINELLAS PARK, FL

# Park Blvd - Retail Space

Pinellas Park, Pinellas County, FL

## CONTACT:

Name: Christian Yepes

Phone: 727-536-8686

Fax: 727-536-4356

Email: christian@bdgfl.com

Access Map



PHONE: 727-536-8686 • FAX: 727-536-4356 • BELLEAIR DEVELOPMENT GROUP